

Micro switches / switching cams

Micro switches

Switches with silver contacts
Switching performance 10 (3) A, 250V AC
With each 1 opener and closer
Plug connections: 6,3 x 0,8mm

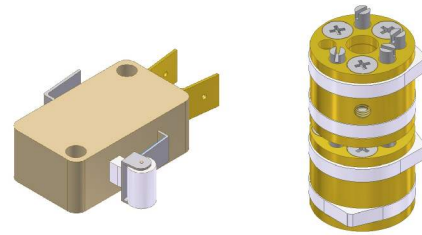

Option

Switches with gold contacts
Switching performance 0,1(0,05) A, 250V AC

Switching cams:

2er or 4er-adjusting cams stepless adjustable
Switching cams with standard switching angle 15°

Standard cam 15°



Cam 180°



Cam 355°



Option

Switching cams with special switching angle 180° or 355°

Switch adjustment

Apply voltage for rotation in left direction (OPEN).
The actuator drives in the adjusted direction.

Depending on the execution, the switching cam shaft turns in
or against the direction of the output shaft
After reaching the adjustable position switch off the voltage.

Attention: Gear must not block.

Now turn the switch cam "S1L" via the adjusting screw "J" in
rotating direction until the corresponding switch „S1L“
switches (clicks).

Drive the actuator again into the final position to check the
programming and eventually adjust again.

Program all other switches / switching cams as described
before.

